

SPECIFICATIONS

Thermodynamic Cycle	Diesel 4 stroke
Air Handling	TAA
Arrangement	6L
Bore x Stroke (mm)	117 X 135
Total Displacement (l)	8.7
Valves per cylinder (n°)	4
Cooling System	liquid
Direction of Rotation (viewed facing flywheel)	CCW
Compression ratio	16:1
Injection System	ECR

PERFORMANCE

Rated power [*] (kW (HP) @ rpm)	269 (366) @ 2150
Peak power (kW (HP) @ rpm)	269 (366) @ 2150
Peak torque (Nm (kgm) @ rpm)	1540 (157) @ 1100
High idle speed (rpm)	2200
Low idle speed (rpm)	± 810
DEF[**]/AdBlue consumption at peak torque and rated power (% of fuel cons.)	8
Minimum starting temperature without auxiliaries (°C)	-15 °
Oil and oil filter maintenance interval for replacement [***] (hours)	600

STANDARD CONFIGURATION

Flywheel housing (type)	SAE 1 - aluminium
Flywheel size (inch)	14"
Intake manifold location	middle high / right side / front
Exhaust manifold location	middle high / left side / back
Turbocharger	fixed geometry with waste gate valve
Turbocharger location	center / left side
Fan transmission ratio	1.03:1
Distance between fan - crankshaft centers (mm)	X = 40 Y = 250
Fuel filter (n°)	single cartridge - right side
Fuel prefilter	-
Fuel Pump	-
Oil filter (n°)	single cartridge - left side
Oil sump	suspended sheet
Oil vapours blow-by circuit	close case ventilation
Oil heat exchanger	integrated into the block
Oil filler	on valve cover
Starter	24V - 4.5kW
Alternator	24V - 90A
Engine stop device	by electronic control unit
Wiring harness	interface wiring loom with accessories
Painting color	grey

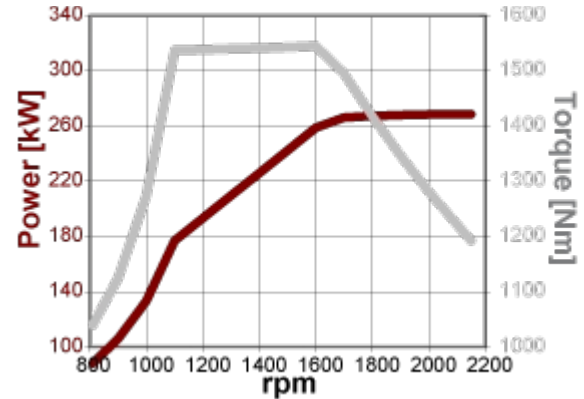

WEIGHT AND DIMENSIONS



NOT INCLUDED IN STANDARD CONFIGURATION

Power Take Off (PTO)	-
PTO - transmission ratio	1.1:1
PTO - maximum available torque	SAE A 120Nm (9 teeth - ANSI B92,1) SAE B 120Nm (13 teeth ANSI B92,1) - 180Nm (splined - DIN 5482) SAE 2B 180Nm (15 teeth - ANSI B92,1)
Battery - minimum capacity recommended [*] (Ah)	180Ah (24V)
Battery - minimum cold cranking capacity recommended [*] (A)	800A (24V)

[*] Power at flywheel according to 97/68 EC (without fan), after 50 hours running, 3% tolerance.

[**] DEF: Diesel Exhaust Fluid.

[***] Oil type: Approved engine oil specification: 15W-40 ACEA E7 / API CI-4 or 10W-30 ACEA E7 / API CI-4.

Legend

Arrangement L (in line)	Air Handling TAA (Turbocharged with aftercooler) TC (Turbocharged) NA (Naturally Aspirated)	Turbocharger WG (Wastegate) VGT (Variable Geometry Turbocharger) TST (Twin Stage Turbocharge)	Injection System M (Mechanical): ECR (Electronic Common Rail) EUI (Electronic Unit Injector)	Emission Standard EEV (Enhanced Environmentally friendly Vehicle)	Exhaust System EGR (Exhaust Gas Recirculation) SCR (Selective Catalytic Reduction)
-----------------------------------	---	---	--	---	---

FOR INFORMATION ON THE AVAILABLE RATINGS NOT LISTED IN THIS DOCUMENT PLEASE CONTACT THE FPT INDUSTRIAL SALES NETWORK OR VISIT OUR SITE WWW.FPTINDUSTRIAL.COM



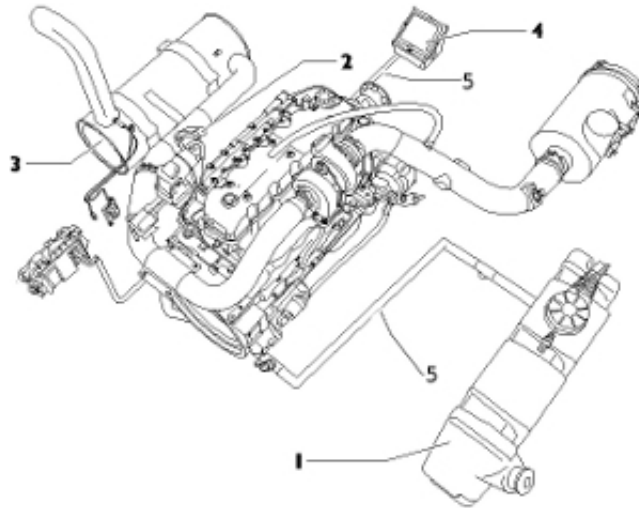

SCR (Selective Catalytic Reduction) system

Main components

- 1) AdBlue/DEF* Tank: available options 61 and 75 liters
- 2) Dosing Module
- 3) SCR muffler: available options Vertical and Horizontal configuration
- 4) Supply Module
- 5) AdBlue/DEF* pipes

*DEF: Diesel Exhaust Fluid

FPT INDUSTRIAL OFFERS THE WIDEST AVAILABILITY OF ENGINE BUILD OPTIONS TO CUSTOMER SPECIFIC REQUIREMENTS WITHIN THE ENGINE SUPPLY. TO FIND OUT MORE ABOUT THE CONFIGURATIONS AND ACCESSORIES WHICH ARE AVAILABLE

